



 basIP

INTERCOM
SOLUTIONS



BAS-IP constantly develops IP intercom systems, introducing innovation into people's lives every year.

The company constantly reviews the user's experience and creates products to improve the quality of life.

12

12 years since it was founded

47

Operates in 47 countries

276

Over 250 large scale projects worldwide

72

More than 25% of projects involve customised software



52

International exhibitions with
BAS-IP participation

3500

Number of apartments served
in the largest residential complex



BAS-IP advantages



Lift control

When connecting the lift control modules, it is possible to implement several convenient functions.

For example, a resident of a complex will be able to use their monitors to open the door to his/her guest, after which the guest will be able to go up only to the floor, where the resident lives. For residents, when ID is provided at the entrance, the lift is able to bring them directly to their floor.

Targeted advertisements

Unit panels can present informational or promotional messages on their screens in standby mode or when motion is detected in front of the panel.

There is also the option to display text or graphic messages in screensaver mode on the video door entry monitor. They can, for example, be announcements about repair works in a complex, or information about the opening of a new restaurant on the premises of the residential complex.





Open API

The BAS-IP R&D team has implemented an API to support large projects, where an intercom system is a part of a large software complex. Entrance panels and video door entry monitors are supported by a powerful JSON API, built using REST architecture, allowing you to easily integrate and manage all of their capabilities.

This is an ideal solution for companies that want to control all devices with full functionality using one system.

ACS

All BAS-IP entrance panels have a built-in controller and universal UKEY reader, which is a ready access control system. Wiegand 26/32/34/37/40/42/56/58/64 support allows you to connect to any third-party controllers and operate doors, gates, and gate arms in a residential complex or office building through third-party software.

The reader can be configured to work at different distances. You can use 3 modes of operation: Touch (1-2 cm), Door (up to 1 metre), and Gate/Barrier (up to 10 metres).





Face recognition

Multi-apartment outdoor panels have a unique feature — 3D face recognition.

This identifying technology is integrated into the BAS-IP panels and uses the camera of the outdoor panel and infrared sensors for its operation.

Once tenants and common visitors are identified, the outdoor panel can automatically unlock and voice an important message or useful information about the residential complex.

The AA-14FB unique multi-apartment panel

The exclusive AA-14FB panel is for the most demanding projects. The appearance of this new panel will please architects, and engineers will delight in a set of new functions.

The panel has a 10-inch touch screen with an intuitive graphical interface and a convenient guest book with the ability to display company logos or photos of apartment owners. Video advertisements, news, as well as individual messages can be displayed while calling or waiting. Downloading individual design and unique welcome melodies will emphasise your originality. The panel supports automatic face recognition when someone comes up, and UKEY mobile access. The open API has been developed to integrate with third party systems.

The AA-14FB panel has been created to operate at temperatures from -40°C up to $+65^{\circ}\text{C}$.



Development of individual interfaces

In addition to standardised solutions that are suitable for most tasks, BAS-IP can offer the development of unique individual interfaces for projects.

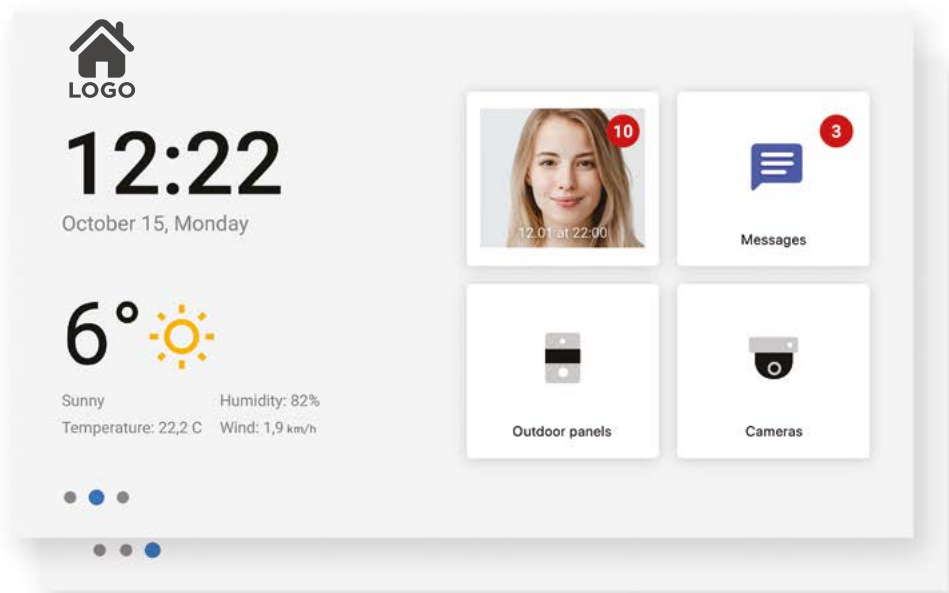

Want to add the logo of the developer serving the company or the residential complex name? It's easy!

We are consistently developing and solving complicated tasks, such as improving the interface, adding new functions, creating unique colours or device designs, and allowing integration with other systems. All this is possible with BAS-IP.

Link

The Link software offers a centralised access control panel allowing you to connect with BAS-IP equipment in residential complexes and office centres of varying complexity. It allows you to flexibly manage all the functionality of the intercom system from anywhere in the world.



You can work with Link on any device: a computer, a tablet, or a smartphone running any operating system.



For data security, a convenient backup and information restore system are provided. No need to worry about the safety of data.



Link is available as a cloud service, while still providing additional privacy, though it can be installed locally for ease of use.

There are several types of system user: Administrator, Manager, User. There is a set of administrative options for each type of account.

Main features

- Link offers accounts with various rights for different types of users: administrators, concierges and residents.
- Create and control objects of any complexity. An administrator can create objects of any size and structure, sort them by groups, and provide concierges and users with various rights within groups.
- Flexible ACS control — the creation of flexible access rules with schedules for each user in the system and automatic download to devices.
- Guest access — providing access to certain areas for a specified time or number of passes for guests directly from your account, by providing visitors with links or QR codes.
- Face ID support — the possibility of downloading residents' photos in Link where they will be converted into hashes and transferred to panels as well as other IDs. They also can be automatically linked to access rules or used for temporary access.
- Decision server access. Panels don't store data about IDs or codes in this mode. However, they are transferred each time to the decision server access.
- Centralised device control: search, add to the system, set up, update and back up.
- The possibility of sending notifications to a selected group of devices — creation of notification rules for groups of devices: specify the device, select MP3 recordings to be played, start automatically at the specified time according to the schedule or manually.
- Built-in telephony server: push notifications in the BAS-IP intercom application, automatic generation of numbering plans depending on users' rights, automatic generation of contacts book directories for panels, automatic entry of telephony settings in the connected devices (SIP settings, forwarding rules).
- Built-in concierge SIP client: receiving and making video calls, panel unlocking, queue/hold/call history, contacts book directory.
- Logging and system audit. The entry of all events from devices: IDs checked, codes entered, unlocking from called device, call records and all the actions in the system and much more.
- Marking log entries support — the possibility of custom markers creation. For instance, «Default» or «Waiting for a delivery».

The Administrator and Manager can create access zones in and between projects, deny access on specified dates and set time intervals by using temporary access restrictions for identifiers and access codes issued to users.

The Administrator can run user polls, and after that, collect statistics (number of people who saw the poll and who participated in it) and results.



For the end-user, Link will look like the usual personal space, they are able to log in from anywhere, he/she can manage the settings installed in their apartment and the BAS-IP intercom system, and give guests access to the complex premises.



Guest access

Residents of a complex can issue guest access to visitors. For example, waiting for a delivery man, you can create special access limited by time or number of passes. Guest access can be used for entering the premises, opening the door of the unit, and being already near the door of the apartment, it's only needed to press the button of the outdoor panel and hand over the delivery. Access to the territory of the complex is carried out by providing visitors with links or QR codes.

LINK

How does it work?

The Resident of the complex (or the manager of the facility) enters the Link personal space, and he/she can see the outdoor panels (and the doors that they control) which are available to the user. After selecting the ones in which access is needed, the system generates a special link which the resident then sends to the guest's phone number (email or messenger). The guest receives the access link. When the guest arrives, he/she opens the link on the smartphone to see each of the panels and the «Open» button. The door can now be unlocked with a push of a button.

The guest access system can be flexibly customised.

You can easily customise:

- Number of passes;
- Access point;
- Time during which these restrictions apply and more.

General connection diagram

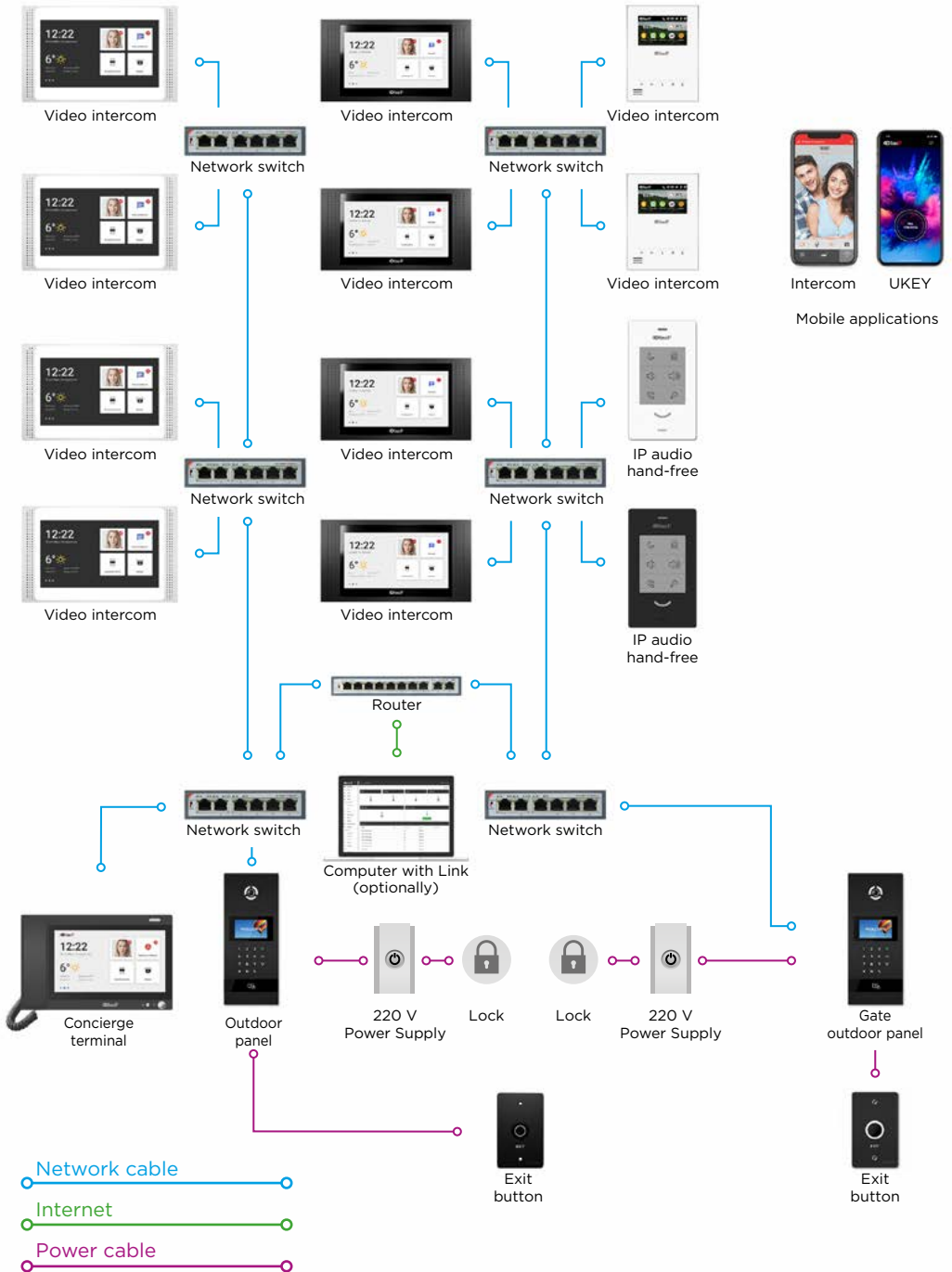

Multi-apartment panels



AA-14FB BLACK/SILVER/GOLD



AA-12FB BLACK/SILVER/GOLD



AA-07B SILVER

Aluminium



AA-07B STAINLESS STEEL

Steel panel

Multi-apartment panels



BI-02FB SILVER/BLACK/GOLD



BI-04FB SILVER/BLACK/GOLD



BI-08FB SILVER/BLACK/GOLD



BI-12FB SILVER/BLACK/GOLD

Individual panels

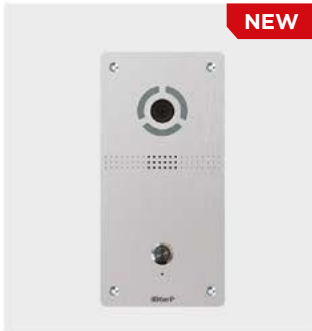

AV-04FD

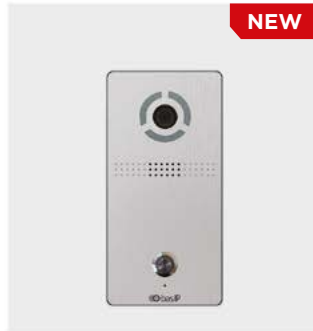

AV-04SD



AV-03D

Catalogue



AV-03BD



AV-01BD/AV-01D



AV-01KD

One button audio panels



AV-04AFD GREEN



AV-04AFD RED



AV-04AFD SILVER

Door Entry Panel Posts



For AA-14FB panel



**For AA-12FB
and AA-07B panels**

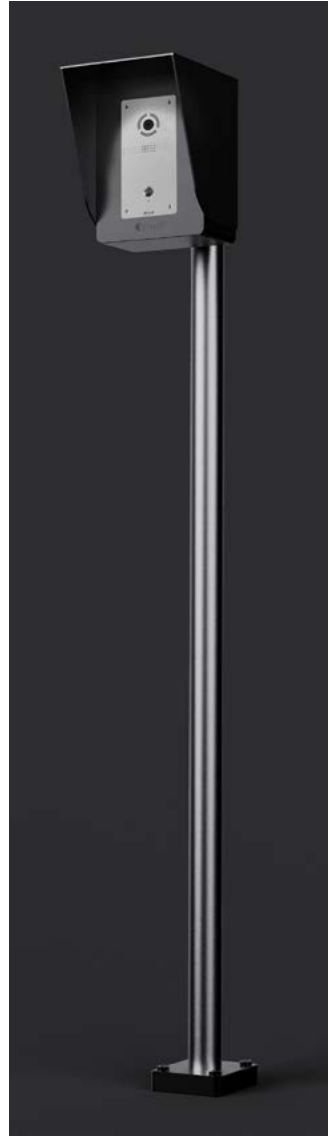

**For AV-04FD
and AV-01BD panels**

Indoor monitors and audio devices

NEW

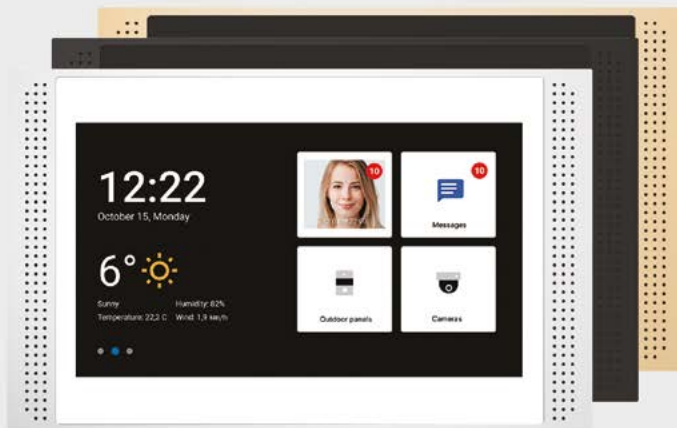

AT-10 SILVER/BLACK/GOLD

Flush and surface wall mount

NEW

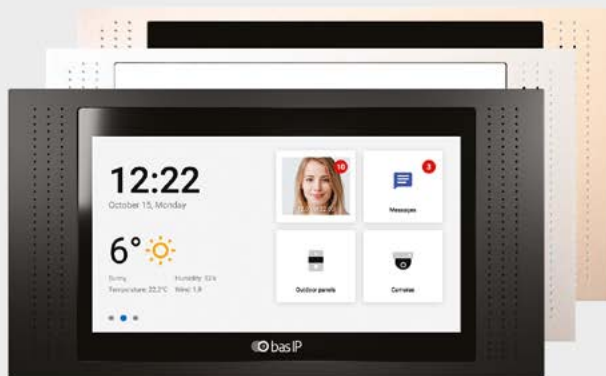

AT-07L BLACK/SILVER/GOLD

Flush and surface wall mount

Indoor monitors and audio devices

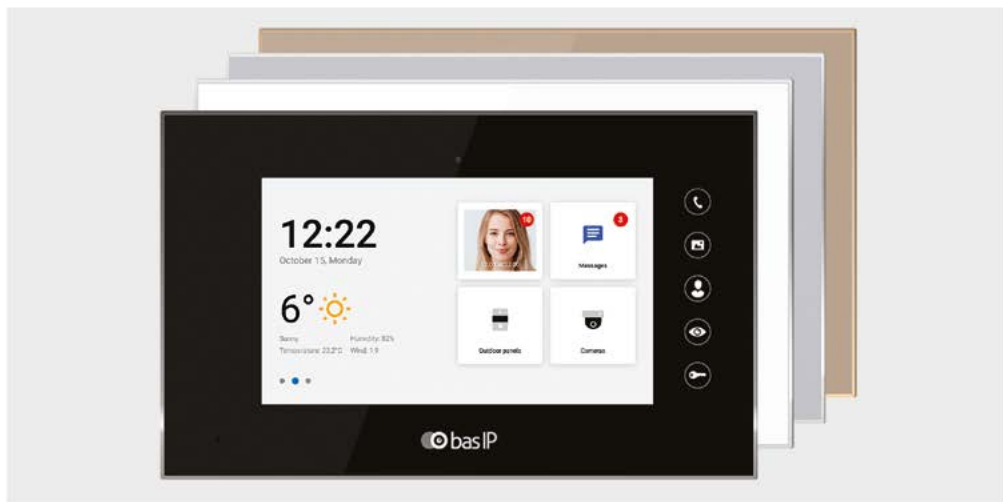

AQ-07LA BLACK/WHITE/SILVER/GOLD



AU-04LA + SP-AU BLACK/WHITE

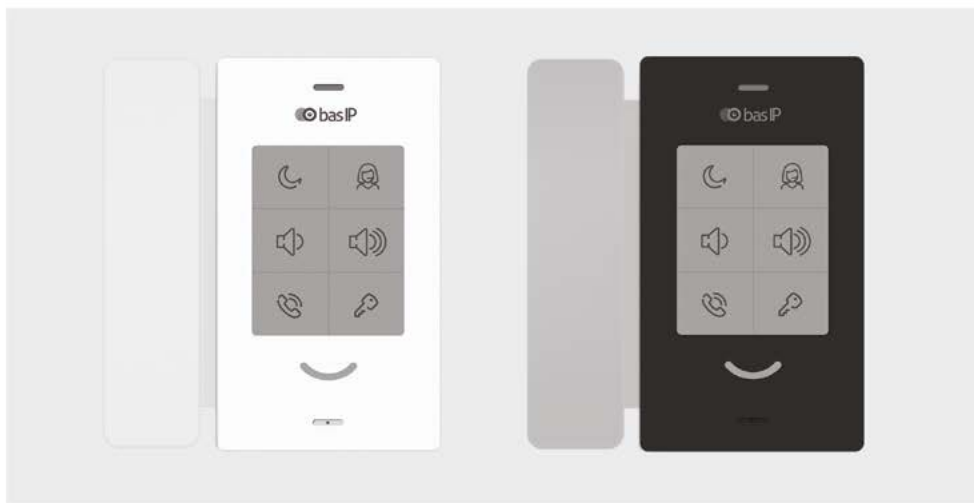

SP-03 + SP-SP WHITE/BLACK

Concierge terminal

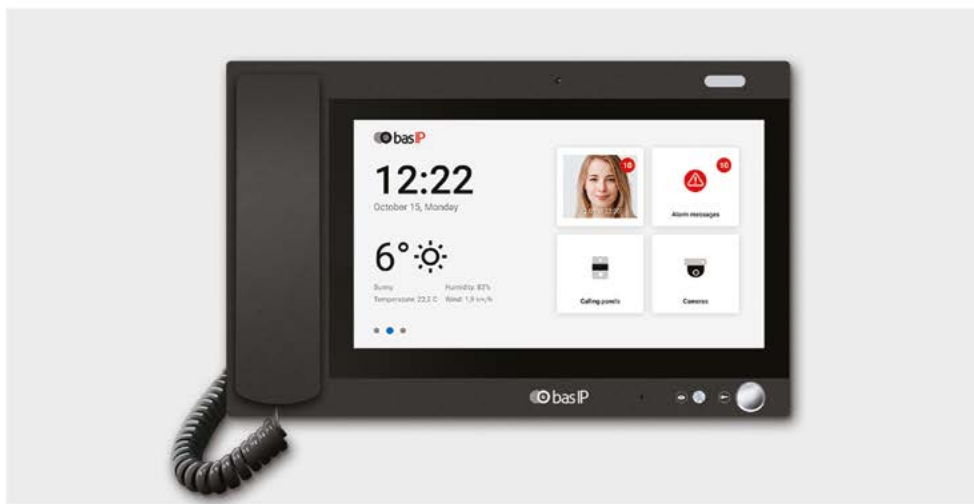

AM-02 BLACK

Accessories



CR-02BD

Standalone network reader with a controller 2 in 1

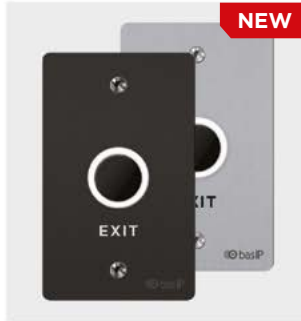

SH-45TE

Touch-free Exit button



SH-45E

Piezo Exit button



SH-46T

Touch-free doorbell

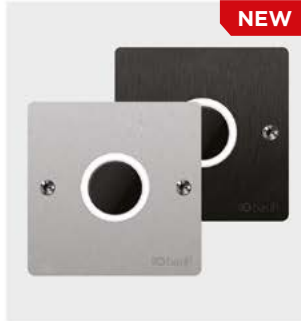

SH-47T

Touch-free button



SH-03

QR code UKEY



UPS-DP/S

Uninterruptible power supply unit



SH-16

Alarm extension module



SH-40

Delay module



SH-42

Two locks control module



SW-01
IP-2-wire converter



SW-02
IP-2-wire converter



SW-08
Switch for two-wire intercom
system upgrading (8 ports)



SW-10
Switch for two-wire intercom
system upgrading (10 ports)



SH-20.4
4-port PoE switch



SH-20.8
8-port PoE switch



SH-20.16
16-port PoE switch



SP-AU
Handset for SP-03



SP-SP
Handset for AU-04L/
AU-04LA



EVRC-IP
Lift controller

Brackets



BR-AA14
SILVER / BLACK / GOLD



BR-AA12/BI
SILVER / BLACK / GOLD



BR-AA STAINLESS



BR-AA



BR-AV



BR-AV2



BR-SH45
SILVER / BLACK

Software



Link



Intercom (Android and iOS)



UKEY (Android and iOS)

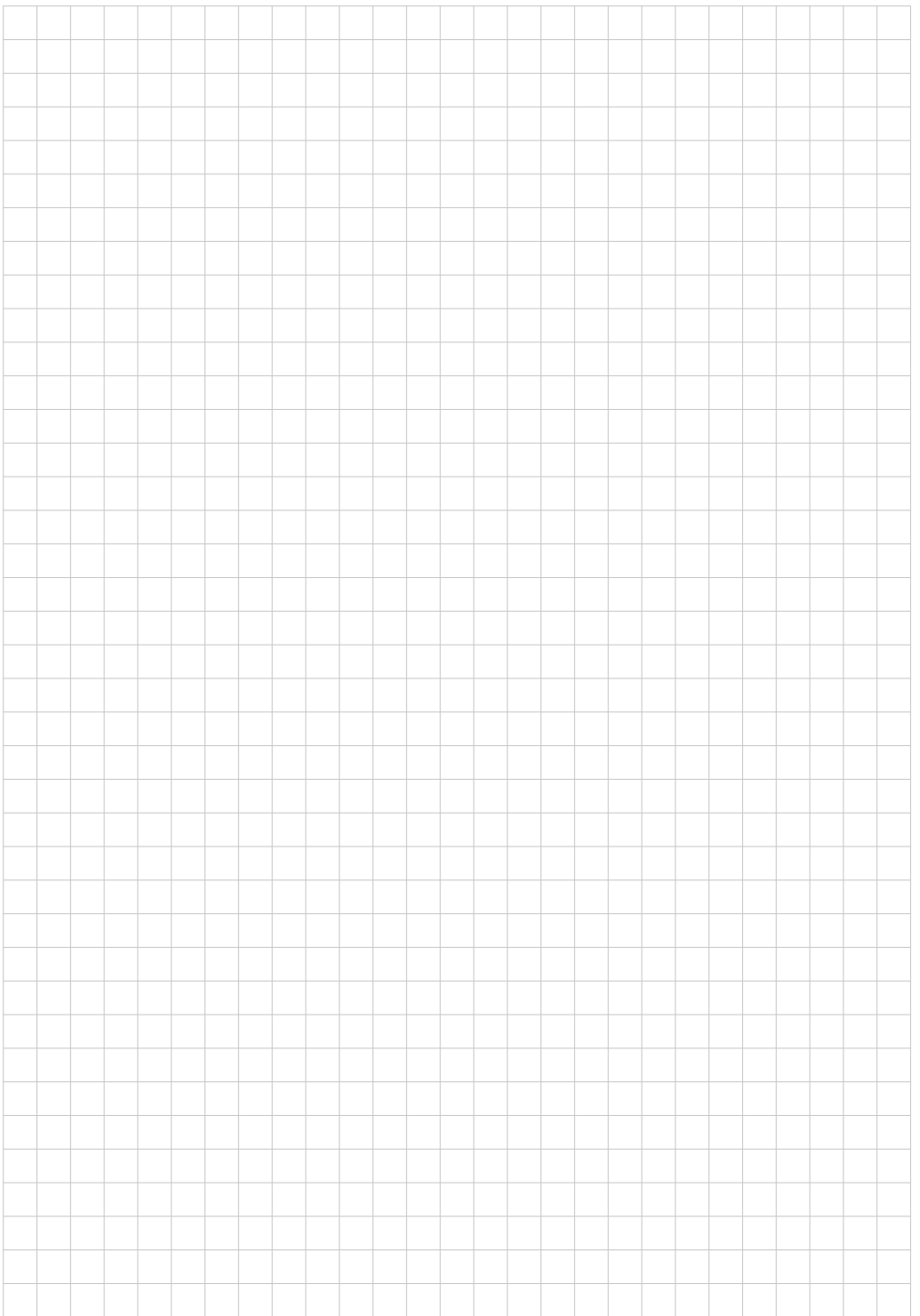





bas-ip.com

